

cd35.2

compact disc player

user's manual

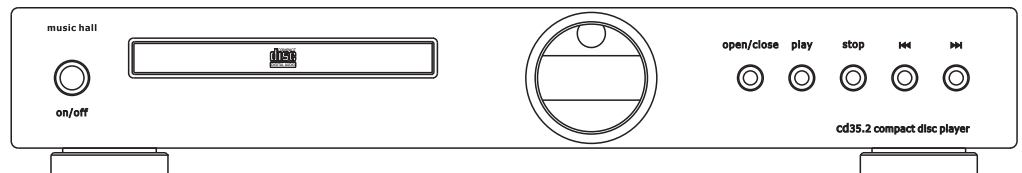

music hall

<http://www.musichallaudio.com>

Congratulations on Your Purchase

You have selected a state of the art cd player. Each component chosen for assembly in the construction of the cd35.2 was selected to provide you with superior performance and the highest level of sound reproduction available today. We know of no cd player that costs as much to produce that sells for so little. Please take a few moments to read over the operating instructions to insure that you get the best performance from your unit and years of trouble-free service.

SAFETY GUIDELINES

This product is designed and manufactured to strict quality and safety standards. However, you should be aware of the following installation and operation precautions:

1. Take heed of warnings and instructions

Read all the instructions before connecting or operating the unit.

Keep this manual so you can refer to these safety instructions. Heed all warnings and safety information in these instructions and on the unit.

2. Water and Moisture

To reduce the risk of fire or electric shock, do not expose the unit to moisture or water. If the unit is exposed to moisture, immediately disconnect the power cord from the wall. Take the unit to an authorized Music Hall service center for inspection. Do not touch the unit, power cord, or plug with wet hands.

3. Object or liquid entry

Do not allow foreign objects or liquids into the unit. If this happens, immediately disconnect the power cord from the wall and take the unit to an authorized Music Hall service center for inspection.

4. Ventilation

You must allow 2 inches (5 cm.) of unobstructed clearance around the unit. Do not place the unit on a bed, sofa, rug, or similar surface that could block ventilation from the bottom. Do not stack another component on top of the amplifier. If the component is placed in a bookcase or cabinet, it must be ventilated to allow proper cooling.

5. Heat

Keep the unit away from naked flames, radiators, heat registers, stoves, or any other heat-producing appliances (including amplifiers).

6. Climate

The unit has been designed for use in moderate climates. Do not attempt to use below 41 degrees Fahrenheit (5 degrees Celsius) or above 95 degrees Fahrenheit (35 degrees Celsius).

7. Rack and Stands

Place the unit on a fixed, level surface strong enough to support its weight. Do not place it on a moveable cart that could tip over. We recommend only using stands approved for use with audio equipment.

8. Cleaning

Unplug the unit from the mains supply before cleaning. The case should normally require only a wipe with a soft lint-free cloth.

9. Power Sources

Only connect the unit to a power supply of the type and voltage described in the operating instructions or specified on the rear panel of the unit.

10. Power cord protection

Connect the unit to the power outlet only with the cord supplied. Do not modify the supplied cable in any way. Do not attempt to defeat grounding and/or polarization provisions. Do not use extension cords. Do not route the power cord where it will be crushed, pinched, bent at severe angles, exposed to heat, or damaged in any way.

11. Non-use periods

If the unit is to be left unused for a long period of time, the power cord should be unplugged from the wall outlet.

12. Damage Requiring Service

Stop using the unit immediately and have it inspected by an authorized Music Hall service center whenever:

1. The power supply cord or plug has been damaged.
2. Liquid has been spilled into the unit.
3. The unit has been exposed to rain.
4. The unit does not operate properly.
5. The unit has been dropped or damaged.
6. Smoke or any unusual smell is detected from the unit.

CAUTION:

IMPORTANT FOR LASER PRODUCTS

1. CLASS 1 LASER PRODUCT
2. DANGER: Visible laser radiation when open and interlock failed or bypassed. Avoid direct exposure to beam.
3. CAUTION: Do not open the top cover. There are no user serviceable parts inside the player, leave all servicing to qualified service personnel.



WARNING!

To reduce the risk of electrical shock, fires, etc.:

1. Do not remove screws, covers or cabinet.
2. Do not expose the unit to rain or moisture.
3. Do not touch the power cord or plug with wet hands.

CAUTION: TO REDUCE THE RISK OF ELECTRIC SHOCK, DO NOT REMOVE COVER. NO USER-SERVICEABLE PARTS INSIDE. REFER SERVICING TO QUALIFIED SERVICE PERSONNEL.



Indicates that the user of this unit must understand important operation and maintenance instructions.



Indicates high-voltage power inside the unit, which will cause electric shock.

Getting Started

Thank you for purchasing the Music Hall cd35.2 compact disc player. It is assembled using hand selected parts, a precision StreamUnlimited CD80 transport and a Burr Brown PCM1738 24bit/192Khz DAC. These combined features guarantee that the cd35.2 will deliver the highest level of audio performance. When used in a top-end audio system, your Music Hall cd player will provide years of enjoyment. The cd35.2 is the perfect complement to Music Hall's a35.2 integrated amplifier.

A Few Precautions

Please read this manual carefully. In addition to installation and operating instructions, it provides valuable information that will help you get optimum performance from your system. Please contact your authorized Music Hall dealer for answers to any questions you might have. In addition, all of us at Music Hall welcome your questions and comments. Save the Music Hall cd35.2 shipping carton and all enclosed packing material for future use. Shipping or moving the cd35.2 in anything other than the original packing material may result in severe damage that is not covered by the warranty. Be sure to keep the original sales receipt. It is your best record of the date of purchase, which you will need in the event warranty service is required.

Placement

Use common sense when placing the cd35.2. Always place the cd player on a level, firm surface. Make sure that the shelf or cabinet can support its weight. Do not stack heavy components on top of the cd35.2. Avoid placing the unit where it may be subject to excessive heat, such as on top of a large power amplifier or near a heat register. For best performance, avoid placing the unit where it may be subject to vibration, such as near a speaker.

Connecting to Other Equipment

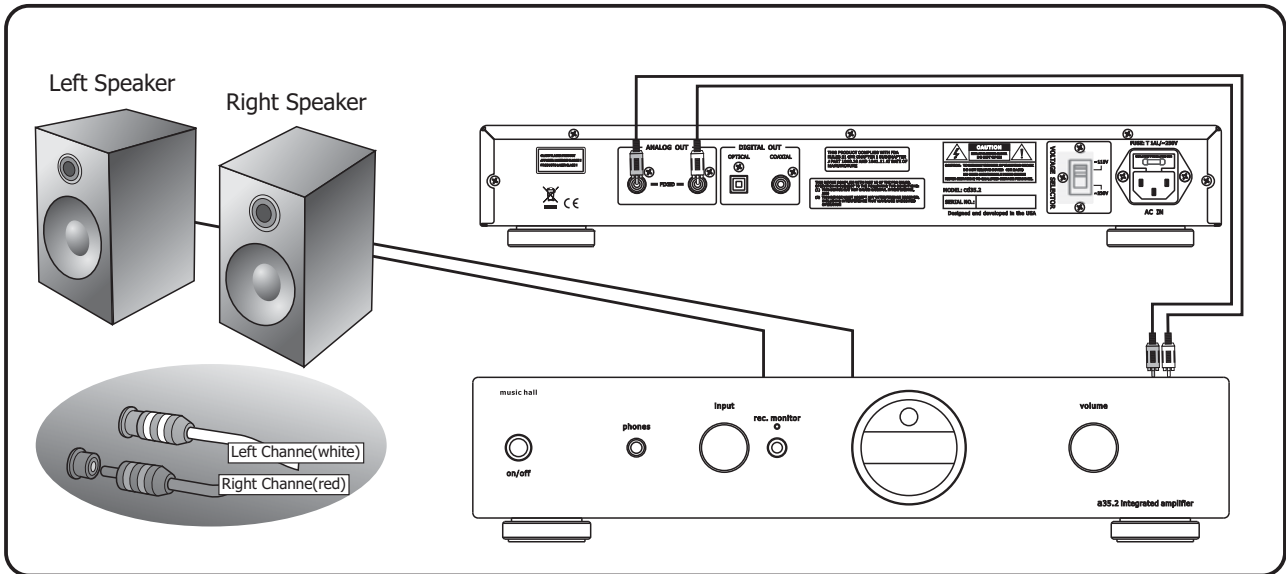

Interconnect Cables

A basic interconnect cable is supplied. Upgrading this cable to one of higher quality may or may not improve the sound quality of the cd35.2.

Audio Output

These outputs are located on the back of your cd35.2 and are labeled ANALOG OUT - FIXED. Connect these outputs to your amplifier's cd input using the supplied cable. Match the Red interconnect lead to the R-ANALOG OUTPUT and the Black interconnect lead to the L-ANALOG OUTPUT.

Digital Outputs

OPTICAL

Use this output to connect to an optical digital input. A suitable optical cable must be used.

COAXIAL

Use this output to connect to a coaxial digital input. A suitable 75 ohm screened cable should be used. Never connect the digital output socket to a conventional audio input.

Connecting to the Mains

Plugging In

Check that the **power** button on the front of the unit is in the **off** position. Push the plug (IEC line socket) of the power cable supplied with the cd35.2 into the socket (POWER INPUT) on the back of the unit. Make sure it is pressed in firmly. Plug the other end of the power cable into an AC wall outlet.

Using Your CD Player

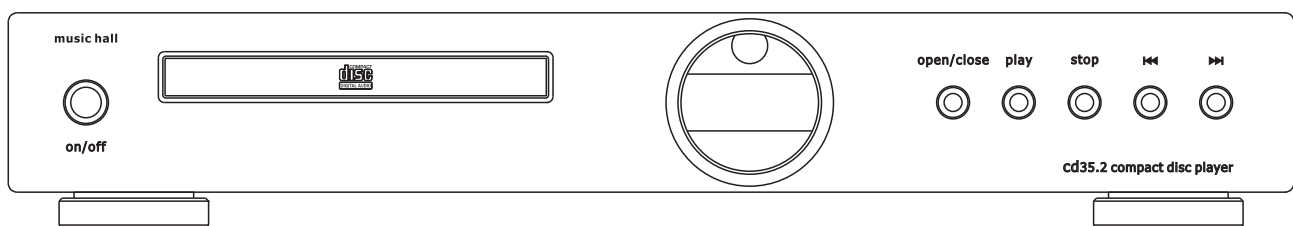

power

Press this button to turn the cd player on and off. When first connecting the unit, make sure this button is in the **off** position.

open/close

To install a cd, press the **open/close** button. The cd tray will open and the display will show, open. Place a cd in the tray, label facing up. Press the **open/close** button again. The cd tray will close and the display will show, load. In a few seconds, the cd player will read the disc and the display will show the total number of tracks and total playing time. The disc is now ready to play.

play

Press to play the cd. The display window will show the track playing and the elapsed time of the track.

stop

Press **stop** to stop the cd. The display window will show the total number of tracks on the disc and the total playing time.

◀◀ And ▶▶ (skip)

To advance forward or backward to different tracks on the disc, press the double arrow button in the direction of the track you wish to hear. Pressing the button multiple times will advance through previous or following tracks. There is no need to hit the **play** button. Once the desired track is located, remove your finger. The player will automatically begin playing your selected track.

Using The Remote Control

Note: Install the two AAA batteries supplied before trying to use your remote control.

The supplied remote control is a standard system remote and therefore not all buttons will function with the cd35.2. The remote controls the cd35.2, a35.2, and t25.2 tuner. For information on using the remote control with the a35.2 and t25.2 refer to their respective manuals.

Do not place anything in front of the display area of the unit, or the remote control may not work.

open/close

Press this button to open and close the cd drawer.

cd/tuner

This button divides the function of the remote between the cd35.2 and the t25.2 tuner. Press the button in for use with the cd player.

buttons numbered 1-0

These buttons allow direct access to individual tracks on the disc. To select a track, press the corresponding keypad button. The player will move to the selected track and begin playing. There is no need to hit the **play** button. For tracks greater than 9, enter the digits in sequence. For example, to play track 13, press 1, then 3. The display will show 13 and the cd will begin playing in a few seconds.

scan

This feature automatically plays the first ten seconds of each track on the disc. To stop scanning and resume normal operation, at the current track, press the **scan** button again. To stop scanning, press **stop**.

repeat

This button allows you to continuously repeat the current track, the entire disc, or a section of one track. Press the **repeat** button once (a T appears on the display) and the current track will repeat. Press the **repeat** button twice (an A appears on the display) and the entire disc (all tracks) will repeat. Press the **repeat** button three times (an A-, appears), this is the start of the section you wish to repeat. Press the **repeat** button again and the display shows (A-B) and the section you've chosen begins to repeat. Press the **repeat** button once more the unit and will cancel the repeat function.

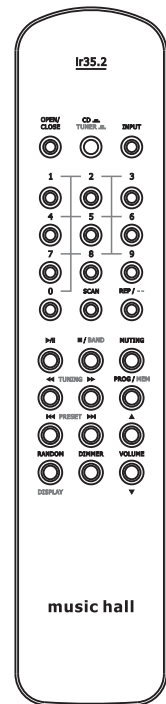

▶/|| (play/pause)

Allows you to start or pause disc playing. Pressing once, starts the disc playing. Pressing again, pauses play. Pressing one more time, resumes play.

■ (stop)

Stops disc playing. Pressing twice will delete a stored program once it has played.

muting

Mutes the cd player's output. The display reads MUTING when the control is active. Press the button again and muting is turned off.

◀◀ (fast backward)

Scans backward while the disc is playing.

▶▶ (fast forward)

Scans forward while the disc is playing.

prog (program)

The **prog** button, allows you to program as many as 16 tracks on the current disc for playback in a specific order. For example, you could program the cd35.2 to play track 5, followed by track 3, followed by track 13. To begin a program:

1. Insert a disc. The cd35.2 will read and display the contents of the disc.
2. Press the **prog** button. The display will show, 00 00:00, indicating that the unit is waiting for the first track to be programmed.
3. Enter the first track number you wish to hear using the keypad buttons numbered 1-0. Your selected track will be shown and the total time of your program will be displayed. Continue entering the rest of your desired selections using the numbered keypad buttons only.

Once you have programmed your playlist, simply press the **play** button. The cd35.2 will begin playing your selected tracks. The cd35.2 will remain in PROGRAM mode until you open the disc drawer or press the **play** button then the **stop** button twice.

While playing a programmed playlist, most functions that would normally affect the entire disc operate on just the memorized program. For example, the **skip** button advances to the next or previous track in the memorized program.

◀◀ (previous)

Skips to the previous track. Pressing the button successively continues this function. Note: There is no need to hit the play button. Once the desired track is located, remove your finger. The player will automatically begin playing your selected track.

▶▶ (next)

Skips to the next track.

random

This instructs the cd player to play tracks from the entire disc in random order. Once all of the tracks have been played, the disc will stop playing.

dimmer

Dims the display. Press the **dimmer** button repeatedly to toggle through the settings.

Technical Specifications

DAC: Burr-Brown PCM 1732 24 bit/192 Khz with HDCD decoder

Transport: StreamUnlimited CD80

Digital Output Connection: Coaxial: 75 ohm and Optical: TOSLINK

Frequency Response: 20Hz - 20KHz(+/-0.5dB)

Harmonic Distortion: <0.0026% (1KHz)

Channel Separation: 100dB

Signal to Noise Ratio: 110dB

Analog Output: 2.1V

Physical

Dimensions: W17" x D14 1/2" x H3"

Weight: 12.8 lbs. pkgd.

Supplied Accessories: Mains Lead, Remote Control, 2 x AAA Batteries, Interconnect Cable

Radio Interference

The cd35.2 is a digital audio device that has been designed to very high standards of electromagnetic compatibility.

CD players and DAC's generate and can radiate RF (Radio Frequency) energy. In some cases this can cause interference with FM and AM radio reception. If this is the case, keep the cd player and its connecting cables as far from the tuner and its antenna. Connecting the cd35.2 and the tuner to different mains sockets may also help to reduce interference.

USA - This product complies with FCC requirements.

Guarantee

This entitles you to have the Music Hall cd35.2 repaired or replaced, at our discretion, free of charge for one year after purchase, at any authorized Music Hall dealer, provided the unit was purchased from an authorized dealer. Your original sales receipt is used as proof of purchase date. Music Hall can take no responsibility for defects arising from accident, misuse, abuse, wear and tear, neglect or through unauthorized repair and or adjustment; neither can Music Hall accept responsibility for damage or loss occurring during transit to or from the person claiming under the guarantee.

Warranty

Your Music Hall cd35.2 warranty covers parts and labor costs for one year from the purchase date. After one year, you must pay for both parts and labor costs. The warranty does not cover transportation costs at any time.

Claims under guarantee

The cd35.2 should be packed in the original packing and returned to the dealer from whom it was purchased, or to an authorized Music Hall Service Center. It should be sent by a reputable carrier carriage prepaid. Do not send the cd player via USPS (United States Postal Service). No responsibility can be accepted for the unit while in transit to the dealer, customer, or authorized service agent, therefore, customers are advised to insure the unit against loss, damage, or theft while in transit.

For further details contact Music Hall LLC:

108 Station Road

Great Neck, NY 11023

T: 516.487.3663

F: 516.773.3891

W: <http://www.musicchallaudio.com>
